

Part #	Prepared By
Project	Notes
Type	
Date	

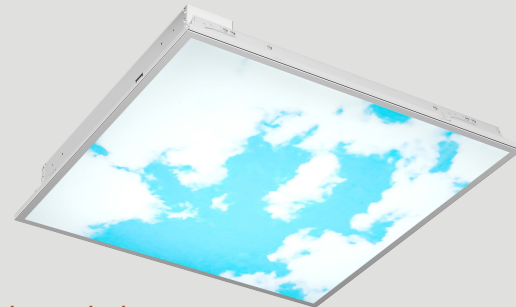

SPT vHealth[®] Scenic Panel Troffer

Recessed Luminaire 1500-4000 Lumens



Scenic Panel shown below

Description

vHealth[®] SPT luminaires are made with cold rolled, 20 gauge aluminum. Luminaire body finish is high reflectance antimicrobial baked white enamel. Wiring knockouts are provided on the back and sides of housing. Door frame with scenic lens secures to housing. This specification grade fixture provides smooth and uniform scenic ambient lighting for patient recovery spaces in healthcare facilities with rigid or grid ceilings.

Electrical & Optics

ELECTRICAL SYSTEM

- 1500 - 4000 lumens
- 3000K - 5000K CCT
- 80 CRI (+90 CRI optional)
- Standard 0-10V dimming driver, optional drivers available
- 120V-277V Input Volts
- Minimum 50,000 hour lifetime at L70

OPTICS & OPTIONS

- Scenic high impact diffuser spreads light to allow for a smooth even glow
- Scenic panel to sooth patient
- Easy to clean
- Optional Opaque White lens for general illumination

FRAME & MOUNTING

- 20 gauge cold rolled aluminum for standard 1" T-bar grid mounting ceiling or rigid ceiling with optional frame or shroud kit
- Multiple 7/8" knockouts and standard access cover allow for easy wiring and installation

Listings

- ETL certified to UL 1598
- Tested according to LM-79 standards
- Rated dry and damp locations
- Buy American Act (BAA)

Warranty & Notes

- 5-year limited warranty on LED module and driver
- IC Rated. insulation may be in direct contact with luminaire

Ordering Information

EXAMPLE: SPT-22L-Y35W-DMV-40K

Series	Size	Wattage	Driver	Kelvin (CCT)	Finish*	Options*
SPT	22L - 23.75"W X 23.75"L	Y20W - 1500 Lumens	DMV 0-10V Dimming	80CRI	BLANK - Antimicrobial Paint White Finish	WP5W
		Y35W - 2500 Lumens	D1MV 0-10V Dimming Dim to 1%	30K - 3000K 35K - 3500K 40K - 4000K 50K - 5000K BCxxxW	AMBK - Antimicrobial Paint Black Finish	WP6W EM20 WHT HCR
		Y45W - 4000 Lumens	G120 ELV/Triac Dimming at 120V only		AMxx - Antimicrobial Paint Custom Finish	FIK1X4 1X4 Frame-in-kit FIK2X2 2X2 Frame-in-kit FIK2X4 2X4 Frame-in-kit SHMOT1X4 1X4 Shroud kit SHMOT2X2 2X2 Shroud kit SHMOT2X4 2X4 Shroud kit

*Options Notes

WP5W - 6ft. 5 wire 18 gauge whip
 WP6W - 6ft. 6 wire 18 gauge whip (dimming EM)
 EM20- 20W Emergency battery backup (remote only)
 WHT - Opaque White lens

*BioSync(R) Notes

BCxxxW - BioSync(R) technology tunable white
 2700k - 5000k
 HCR - 90CRI

Vantage reserves the right to change components, finishes or design details in any manner which does not alter the installed appearance or reduce performance and intended function.

vHealth[®] is a registered trademark of Lexington Lighting Group, LLC dba Vantage Lighting

SPT vHealth® Scenic Panel Troffer

Recessed Luminaire 1500-4000 Lumens

Dimensional Data

CEILING CUTOUT		
2X2	23"	23"

Side View

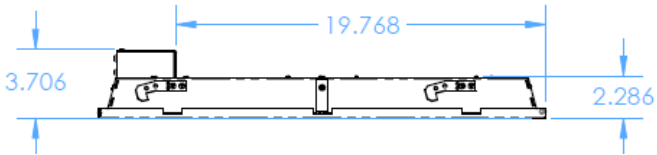

Front View

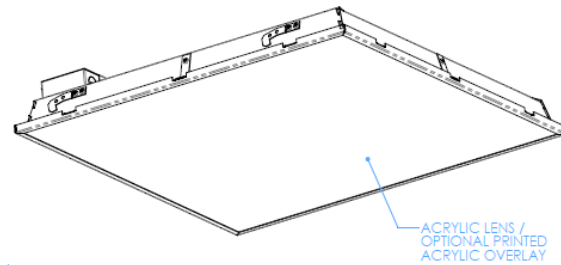
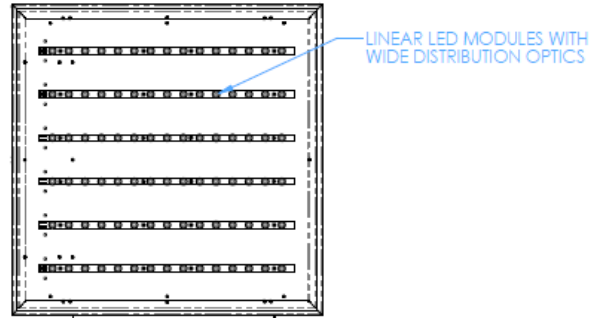

End View

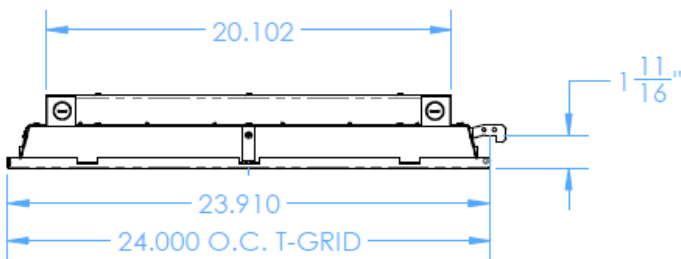

Rear View

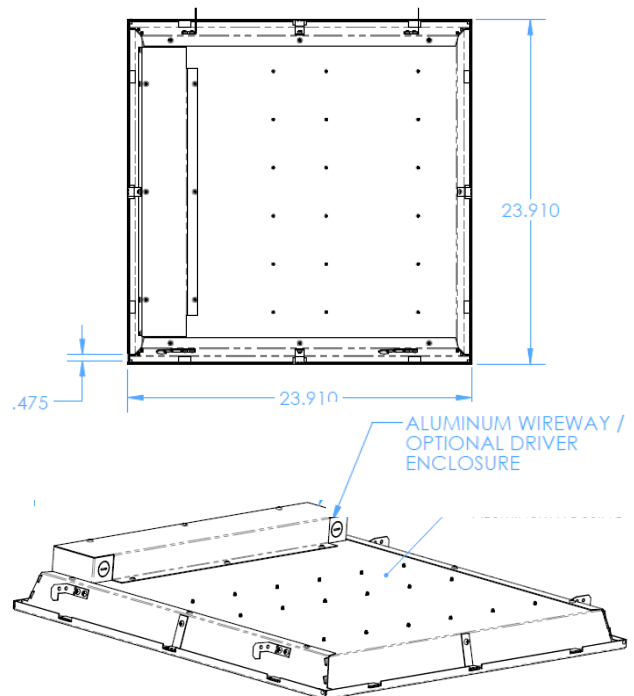

Vantage reserves the right to change components, finishes or design details in any manner which does not alter the installed appearance or reduce performance and intended function.

vHealth® is a registered trademark of Lexington Lighting Group, LLC dba Vantage Lighting

SPT vHealth® Scenic Panel Troffer

Recessed Luminaire 1500-4000 Lumens

Scenic Panel



Other panel designs available. Contact your authorized vHealth(R) agent for alternate designs.

SPT vHealth® Scenic Panel Troffer

Recessed Luminaire 1500-4000 Lumens

Luminance Summary

SPT-22L-Y55W-D1MV-30K

Illuminance - Cone Of Light Isoillumination Plot

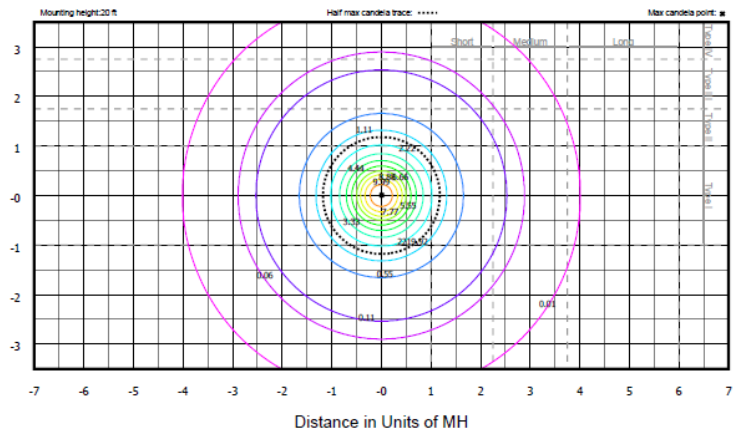
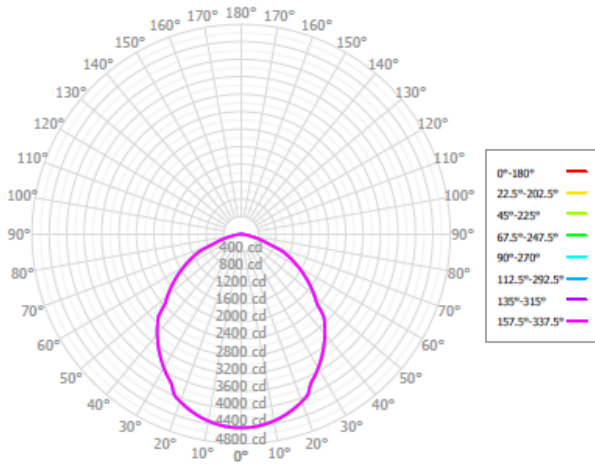

Vantage reserves the right to change components, finishes or design details in any manner which does not alter the installed appearance or reduce performance and intended function.
vHealth® is a registered trademark of Lexington Lighting Group, LLC dba Vantage Lighting